

FOR-X

X108S

Owner's Manual

Dimensions

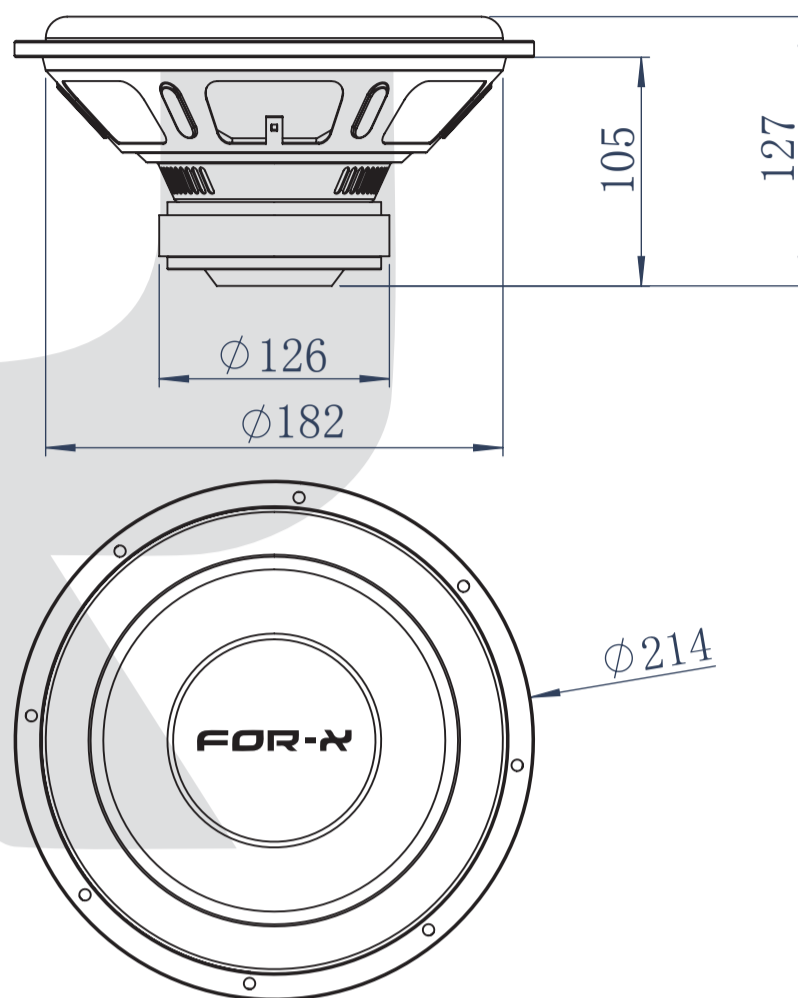

148*210mm

148*210mm

SEALED ENCLOSURE

| SUBWOOFER | RECOMMENDED SEALED ENCLOSURES | | | | |
|--------------|-------------------------------|---|---------|---------|------|
| | Volume (net int) | External Dimensions (Width x Height x Depth) | F3 (Hz) | Fc (Hz) | Qtc |
| X108S | 0.88 cu.ft 25 liters | 11.61in.x11.61in.x15.35in. 295mm x295mm x390mm | 69.6 | 56 | 0.63 |

BOARD THICKNESS: 15mm(0.6in)

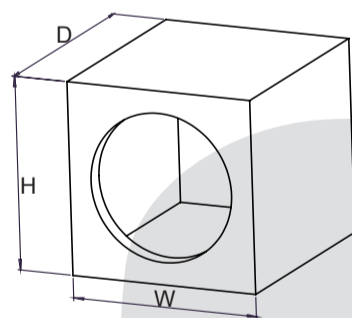

PORTED ENCLOSURE

| SUBWOOFER | RECOMMENDED VENTED ENCLOSURES | | | | |
|--------------|-------------------------------|---|---|---------------|---------|
| | Volume (net int) | External Dimensions (Width x Height x Depth) | Slot Port Internal Dimensions (Port Hole S x Long SL) | Tune to: (Hz) | F3 (Hz) |
| X108S | 1.24 cu.ft 35 liters | 15.75in.x11.61in.x15.35in. 400mm x295mm x390mm | 2.76in.x5.39in 70mm x136.8mm | 56 | 34 |

BOARD THICKNESS: 15mm(0.6in)

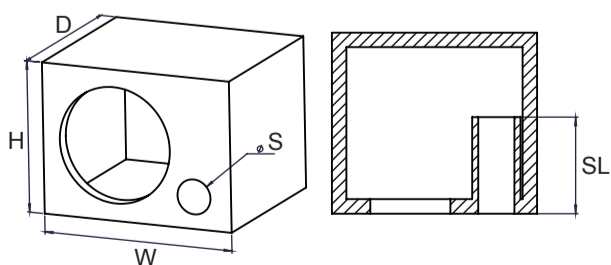

Specifications

| General Data | | |
|----------------------------------|-----|-----------------------|
| | | X108S |
| Overall Dimensions | DXH | 214*127mm |
| Nominal Power Handling | | 200W |
| Transient Power 10ms | | 400W |
| Sensitivity | dB | 82.3 |
| Frequency Response | | 56Hz-300Hz |
| Cone Material | | PAPER |
| Net Weight | Kg | 3.03kg |
| Electrical Data | | |
| Nominal Impedance | Z | 4 Ohms |
| DC Resistance | Re | 3.3 Ohms |
| Voice Coil and Magnet Parameters | | |
| Voice Coil Diameter | DIA | 50.8mm |
| Voice Coil Height | | 21.4mm |
| HE Magnetic Gap Height | HE | 8mm |
| Max.Linear Excursion | X | 6.7mm |
| Voice Coil bobbin | | Aluminium |
| Voice Coil Wire | | Coper |
| Number Of Layers | | 4L |
| Magnet System Type | | High Flux Ferrite |
| BL Product | BL | 12.01 N.A |
| T-S Parameters | | |
| Suspension Compliance | Cms | 0.08 |
| Mechanical Q Factor | Qms | 5.27 |
| Electrical Q Factor | Qes | 0.78 |
| Total Q Factor | Qts | 0.68 |
| Moving Mass | Mms | 96 |
| Eq.Cas Air Load(liters) | VAS | 4.67Lit |
| Resonant Frequency | Fs | 56Hz |
| Effective Piston Area | SD | 201.06cm ² |



148*210mm

148*210mm